

Track Components

TRT989200

INSTALLATION SHEET

START FROM HERE

- Make sure **POWER** is **COMPLETELY OFF** at the fuse box
- Have your fixture installed by a qualified licensed electrician
- Prepare everything in a clear area
- Wear gloves at all time during this installation
- Read instructions carefully before you start assembly
- Keep this installation sheet for future reference

Technical Support: 1-855-855-8926

Please Note:

- All Trilo Track System parts sold separately

Mounting Track

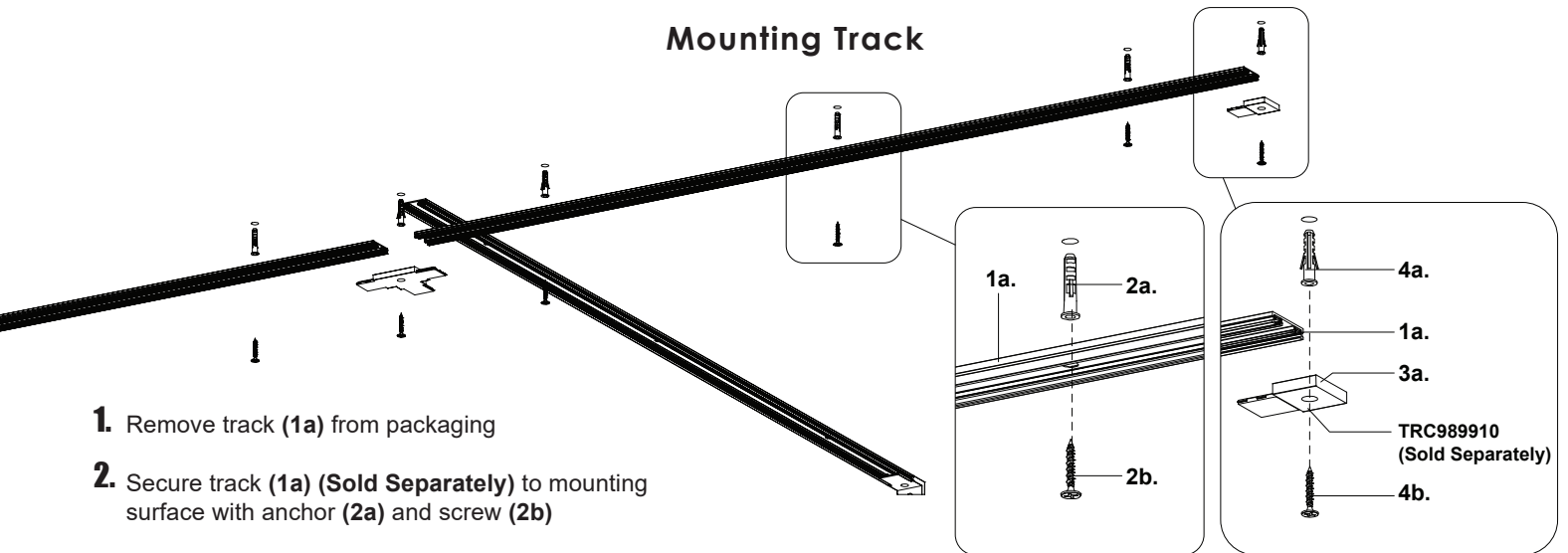

1. Remove track (1a) from packaging
2. Secure track (1a) (Sold Separately) to mounting surface with anchor (2a) and screw (2b)
3. Unclosed track ends must be supported by TRC989910 end connector (3a) (Sold Separately). Attach TRC989910 end connector (3a) to track (1a) and secure to mounting surface with anchor (4a) and screw (4b)
4. Attach track cover (1b) to track (1a) (See Illustration 1)

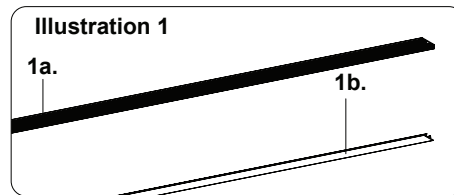

Multiple Power Supplies

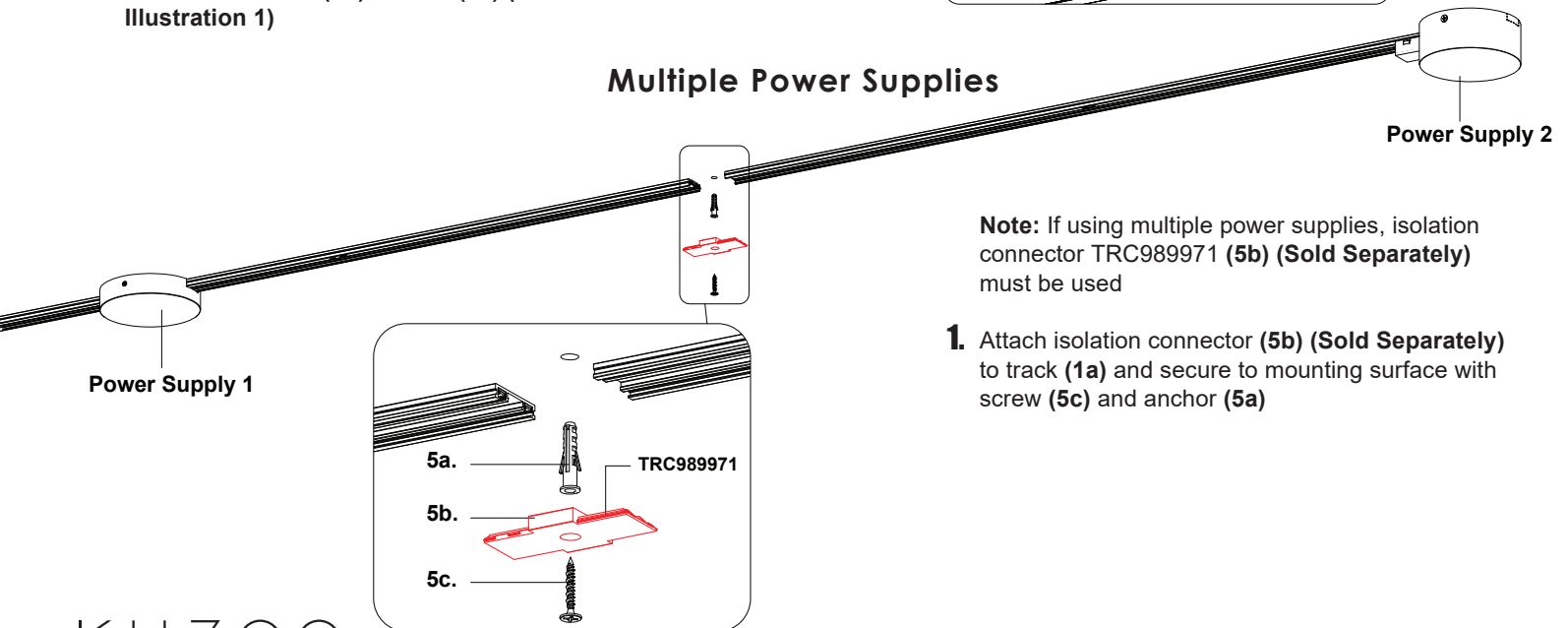

Note: If using multiple power supplies, isolation connector TRC989971 (5b) (Sold Separately) must be used

1. Attach isolation connector (5b) (Sold Separately) to track (1a) and secure to mounting surface with screw (5c) and anchor (5a)

KUZCO

19054 28th Avenue Surrey, BC Canada V3Z 6M3
 T: 604 538 7162 TF: 1-855 85 KUZCO F: 604 538 7196
 W: kuzcolighting.com
 20240912